

The **Pied** Avocet **Parkes** display & expo

...the perfect choice for your Indoor literature stand needs

The Pied Avocet is a popular range of collapsible aluminium literature stands that are stylish and highly portable, making them ideal for exhibitions and displays.

Features & Benefits

- ✔ High tech styling with either A5, A4 or A3 capacity shelving
- ✔ 6 Double-sided acrylic shelves (7 for the A5)
- ✔ Folds down for easy transportation
- ✔ Available in anodised silver
- ✔ Portable, lightweight and quick to assemble
- ✔ No tools required
- ✔ Sizes available:
1420 (h) x 470 (w) x 370mm (d) - 11kg
1460 (h) x 256 (w) x 370mm (d) - 7.5kg
1115 (h) x 210 (w) x 284mm (d) - 6kg
- ✔ Packs into free heavy duty hard case for storage and transportation
- ✔ Special package discount for multiple quantities
- ✔ Full design and artwork enhancement service available



The Pied Avocet Literature Stand

**Exhibiting
Made
Smarter**

Hardware Specifications

Assembled dimensions:

A3: 1420 (h) x 470 (w) x 370mm (d)
A4: 1460 (h) x 256 (w) x 370mm (d)
A5: 1115 (h) x 210 (w) x 284mm (d)

Closed dimensions:

A3: 110 (h) x 470 (w) x 400mm (d)
A4: 110 (h) x 256 (w) x 400mm (d)
A5: 120 (h) x 210 (w) x 320mm (d)

Overall tray dimensions:

A3: 320 (h) x 465mm (w)
A4: 320 (h) x 255mm (w)
A5: 235 (h) x 195mm (w)

Overall tray dimensions:

A3: 305 (h) x 437mm (w)
A4: 305 (h) x 220mm (w)
A5: 218 (h) x 159mm (w)

Assembly Instructions

Important: Ensure fingers are kept clear of folding mechanism when opening and closing the unit



Slide locking tab away from pivot arm at base of unit. Repeat for 2nd locking tab.

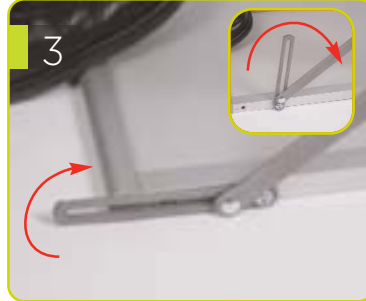

Whilst raising the unit note position of the pivot arms. To ensure correct assembly both pivot arms must rotate through 180 degrees.



Holding the top tray, gently raise the trays upwards. Place your foot on the base to aid stability.

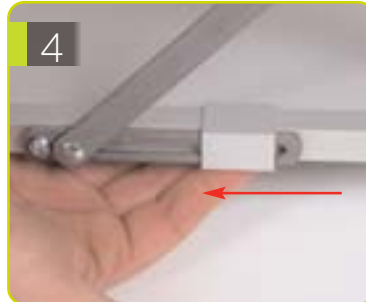

Slide locking tab over pivot arm at base of unit. Repeat for 2nd locking tab.



To close:

1. Slide the locking tabs away from the pivot arms at the base of unit.
2. Lift the top tray and gently lower into the closed position. **(DO NOT DROP)**