

Tension fabric systems are the next generation in large format graphic displays. The Mandarin is portable and easy to set up, offering maximum impact with minimal fuss!



Features & Benefits

- ✓ Fabric graphics remains attached to the expanding frame
- ✓ Optional spot lights available
- ✓ Portable, lightweight and quick to assemble
- ✓ No tools required
- ✓ Available in 3x2, 3x3 and 3x4 straight formats
- ✓ Stabilising feet are available
- ✓ Wheeled carry bag available for storage and transportation
- ✓ Special package discount for multiple quantities
- ✓ Full design and artwork enhancement service available

Frame dimensions (NB see templates for graphic details)

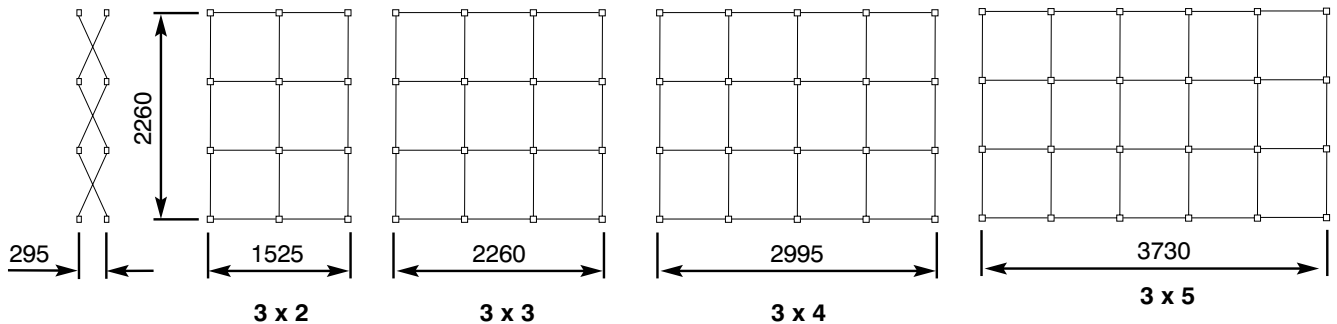

All dimensions are in mm and are approximate

Hardware Specifications

Overall assembled dimensions (mm):

**3x2 Straight Mandarin**  
2260 (h) x 1525 (w) x 295mm (d)  
Weight: 5.75kg

**3x3 Straight Mandarin**  
2260 (h) x 2260 (w) x 295mm (d)  
Weight: 7.75kg

**3x4 Straight Mandarin**  
2260 (h) x 2995 (w) x 295mm (d)  
Weight: 10.25kg approx

**3x5 Straight Mandarin**  
2260 (h) x 3730 (w) x 295mm (d)  
Weight: 12.75kg approx



Ask us for your copy of The Display Book, Promotional Gifts Catalogue, Exhibition Tips and Print Brochure, all packed with ideas to help you promote your company.

Call 01767 603930  
or email

sales@parkesprintgroup.com

We are continually improving and modifying our product range and reserve the right to vary the specifications without prior notice. All dimensions and weights quoted are approximate and we accept no responsibility for variance. E&OE.





1 Hold the frame vertically and begin to expand outwards.



2 Continue to expand the frame until the graphic image appears.



3 Push the frame tubes together to fully extend the system.

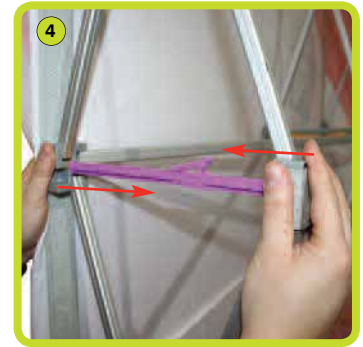

4 Push fit together each pair of locking arms. Repeat for all the remaining arms.



5 Wrap both vertical graphic ends tightly around the frame and fasten using hook & loop fastener.



NB The Mandarin frame may also be assembled flat on the floor if space allows then stood upright

Other customers have bought these products to communicate their sales message



Design & Print | Exhibition & Display

POS | Brochures | Mailers | Catalogues | Posters | Folders | Corporate Stationery | Labels | Inserts | Promotional Gifts

Let your marketing print & display take flight



Parkes Print & Design | 41 Hitchin Street | Biggleswade | Beds | SG18 8BE

T: 01767 603930 | E: sales@parkesprintgroup.com | W: www.parkesprintanddesign.com